

NEOX

ASSEMBLY MANUAL

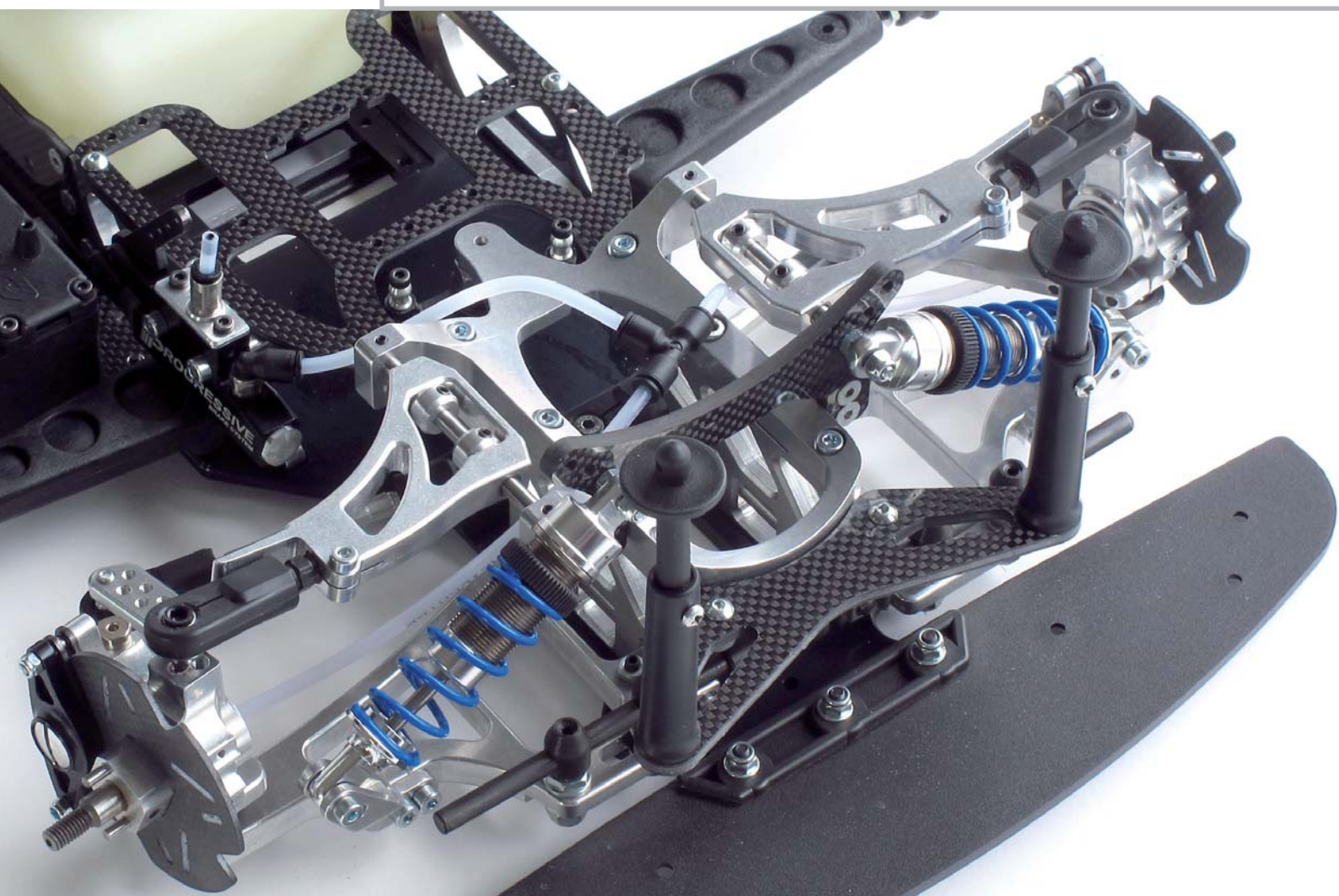

INTRODUCTION

Esteemed friend, thank you for your purchase of the CONTRAST NEOX Q. This product that you are going to assemble is the result of many years of testing, study and development by a large team of highly qualified people. The aim of CONTRAST project is to offer you a high competition car of scale 1:5 with more features and possibilities than the rest of the existing models and brands. But we also wanted to create a simple car, easy to assemble and dismantle, resistant to bumps and to wear and tear, with a high quality manufacturing and besides... it had to be light.

I believe we have achieved that complex aim with the car you have in your hands, and because of this we hope that you enjoy assembling your CONTRAST NEOX Q and get excited about pushing it to the limit on the track.

CONTRAST is an open-minded brand and we wish to know our customer's opinions, as well as the proposals, criticisms, complaints and everything you want to communicate to us, without forgetting the ideas you may have to make the car evolve. You can get into touch with us either by the postal address below or through the next links in internet:

Web official:	www.contrast-racing.com
Facebook:	Contrast Racing - the official site
Twitter:	Contrast_Racing

Now you are part of the CONTRAST TEAM

Yours sincerely

Daniel Fuertes
Contrast Manager

CONTRAST RACING S.L.

Ses Falques 4, local 13
17300 Blanes (Girona) Spain
info@contrast-racing.com

You will find more information and news about Contrast products on our webs site:

www.contrast-racing.com
www.contrast-racing.com/shop

WARNINGS:

- Before starting the assembly read carefully the first pages of this handbook.
- Follow this handbook's instructions through the assembly to get a proper assembly and a perfect adjustment of all the pieces.
- Keep this handbook after the assembly as it may be a help at any moment.
- Contrast Neox Q has been designed to be used on smooth asphalt surfaces. Any use out of these conditions may cause breaking or premature wear and tear of its mechanical pieces.
- Use original spares and replace worn pieces by the same reference number from the Contrast listing. The use of other brands may cause bad behaviour of the vehicle or even a breakdown.
- Contrast Racing S.L. does not take any responsibility for the use that may be given to this product.
- No section of this handbook can be reproduced without a previous consent.
- Due to the continuous evolution of our products, it is possible that any image or explanation of this handbook does not coincide exactly with the real pieces they refer to.

REQUIRED EQUIPMENT

For the right working of the Contrast Neox you will need the following additional equipment, not included in the kit:



Two or three channel transmitter with batteries, receiver and frequency.



Two or three standard or big size 1:5 servos



Battery pack for the radio system and servos' working



Unleaded petrol mixed with oil

NECESSARY TOOLS

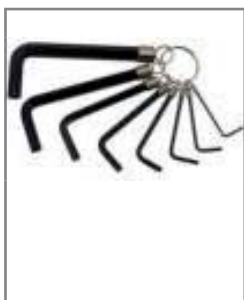

Allen tools 1.5, 2, 2.5, 3, 4 y 5



plane tools 5.5, 7, 8, 10, 13, 17



Screwdriver, philips type



Screwdriver plane



cut pliers



Tip pliers



Clips pliers



Cutter



Scissors



Calibre



Plastic hammer



grease and oils



Soft screwlock



Medium screwlock



Alcohol or cleaners

CONTRAST NEOX Q ASSEMBLY MANUAL

STEP 1 - FRONT UPRIGHT

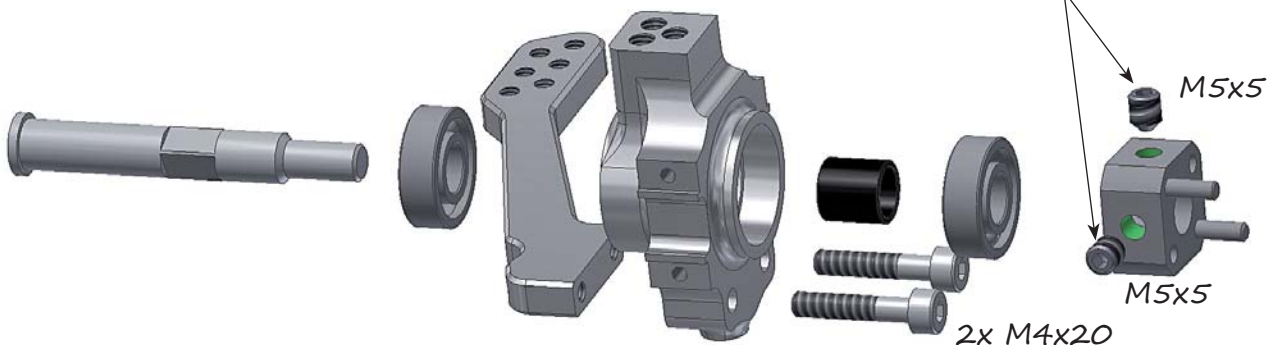

STEP 2 - SERVO SAVER

The servosaver is a really very important piece in the car. This servosaver is adjustable in hardness with the wingnut that presses the conic shims which work as hard spring. Adjust the nut M8 till start to press the washers. The good pressure is when the Nut and the upper side of brass shaft are in same higher.

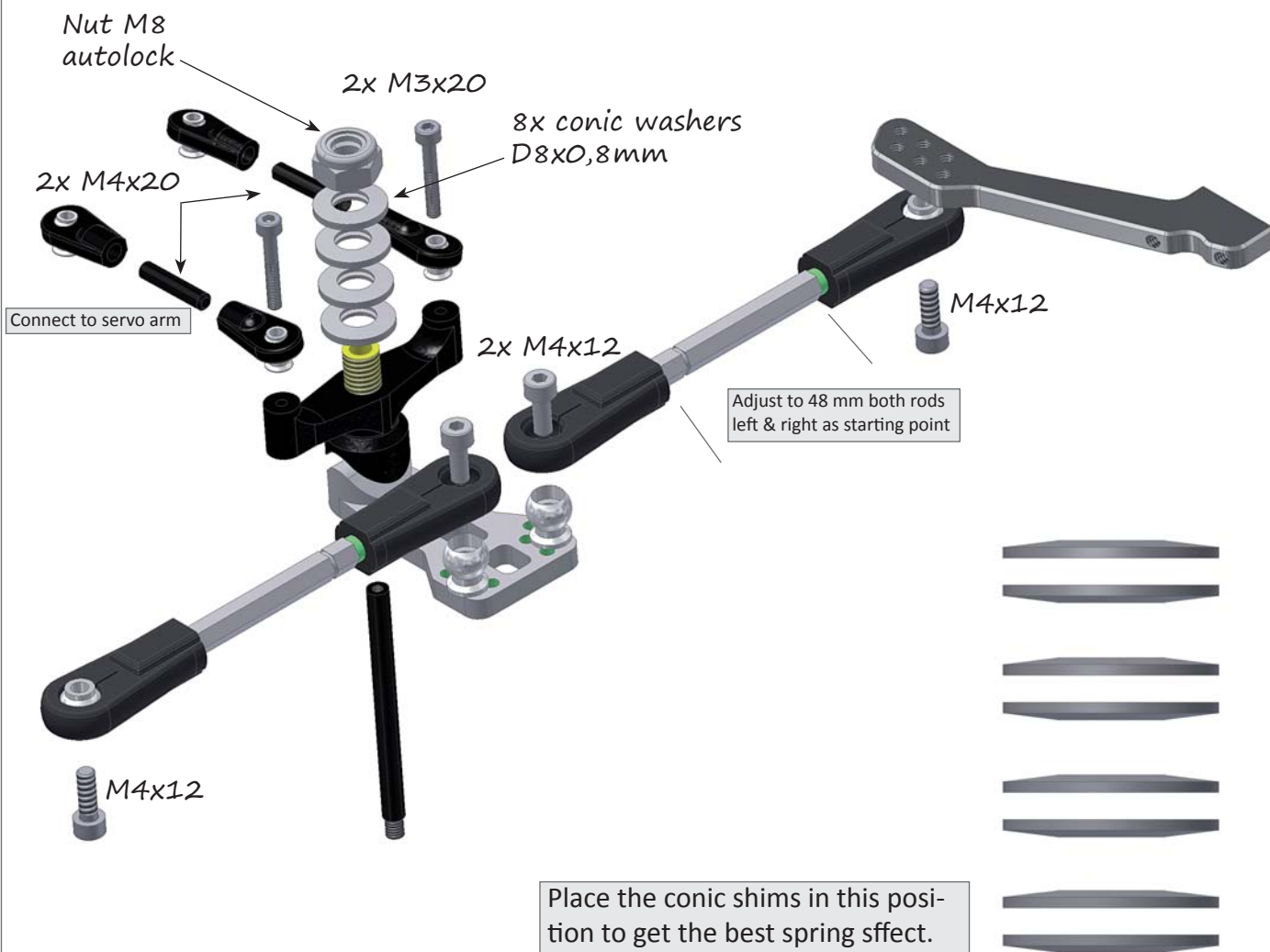

Remember apply liquid screwlocker with soft hardness in all the threads of screws or nuts. Special critic points that need higher hardnes of screwlocker will be detailed in the draws

STEP 3 - FRONT LOWER WISHBONE

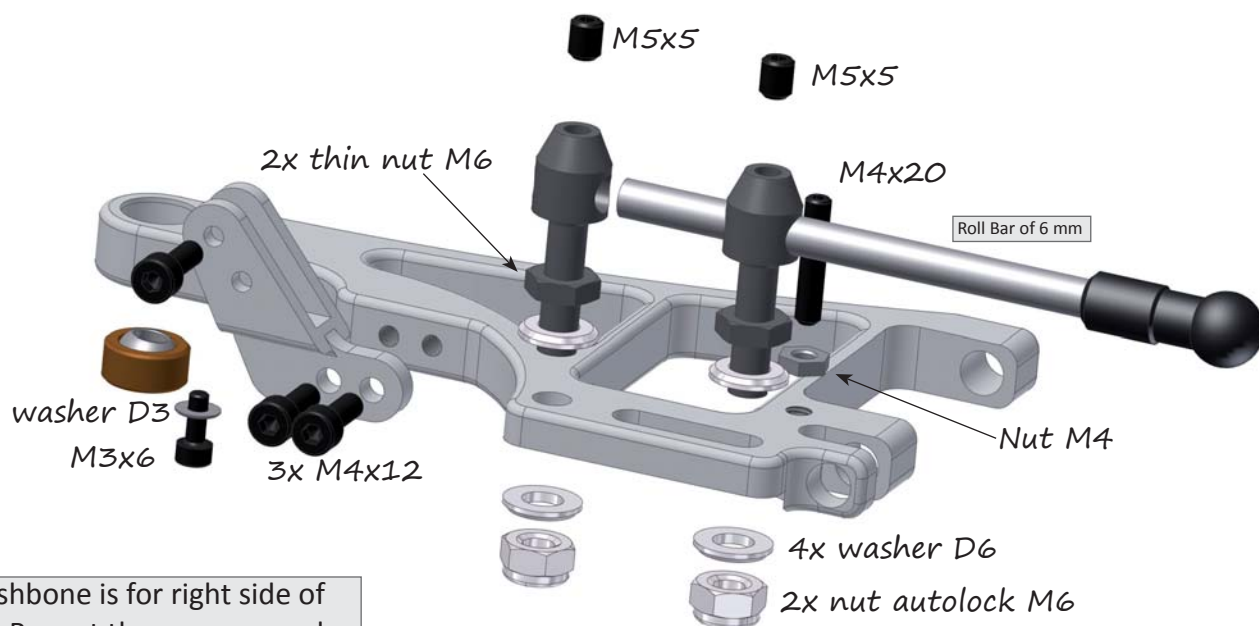

This wishbone is for right side of the car. Repeat the same assembly in the wishbone for left side

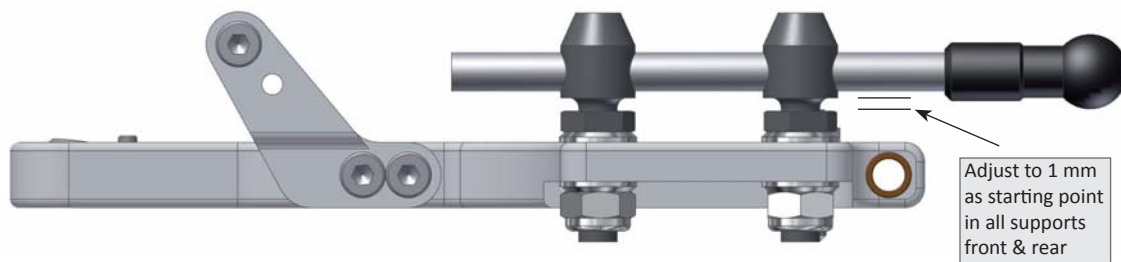

Remember apply liquid screwlocker with soft hardness in all the threads of screws or nuts. Special critic points that need higher hardnes of screwlocker will be detailed in the draws

STEP 4 - FRONT BODY SUPPORT

Cut one section if your bodyshell need a lower position of the pin

Round head 3x10

Round head 3x10

Round head 2x M4x10

2x Washer D4

2x M4x14

Adjust the height of the two pins depending on the type of body and the inclination of the front.

STEP 5 - FRONT AXLE

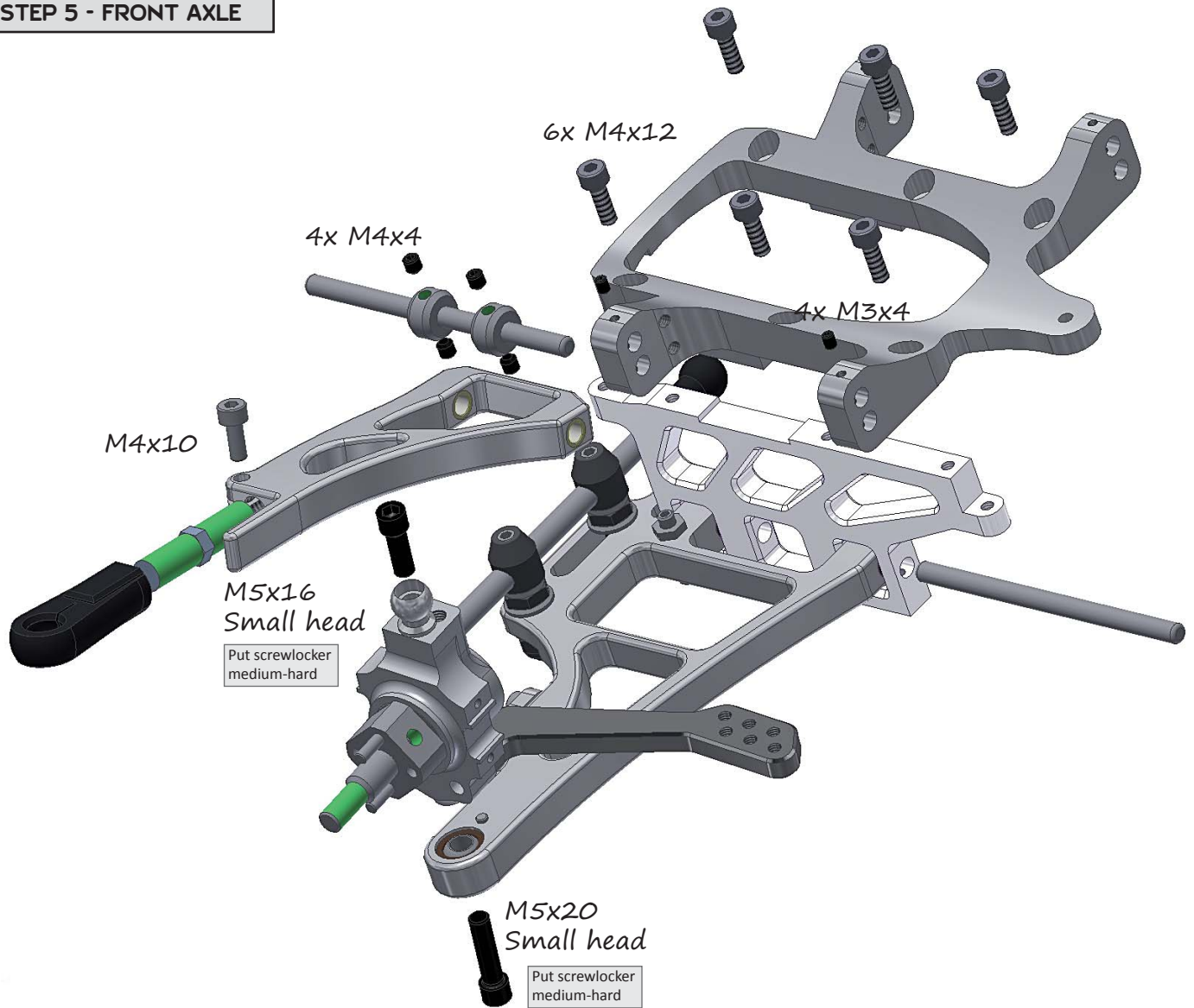

Before assembling the shock absorbers verify that the movement of the wishbones is soft in its entire course with no frictions or hard points.

STEP 6 - FRONT DAMPER SUPPORT

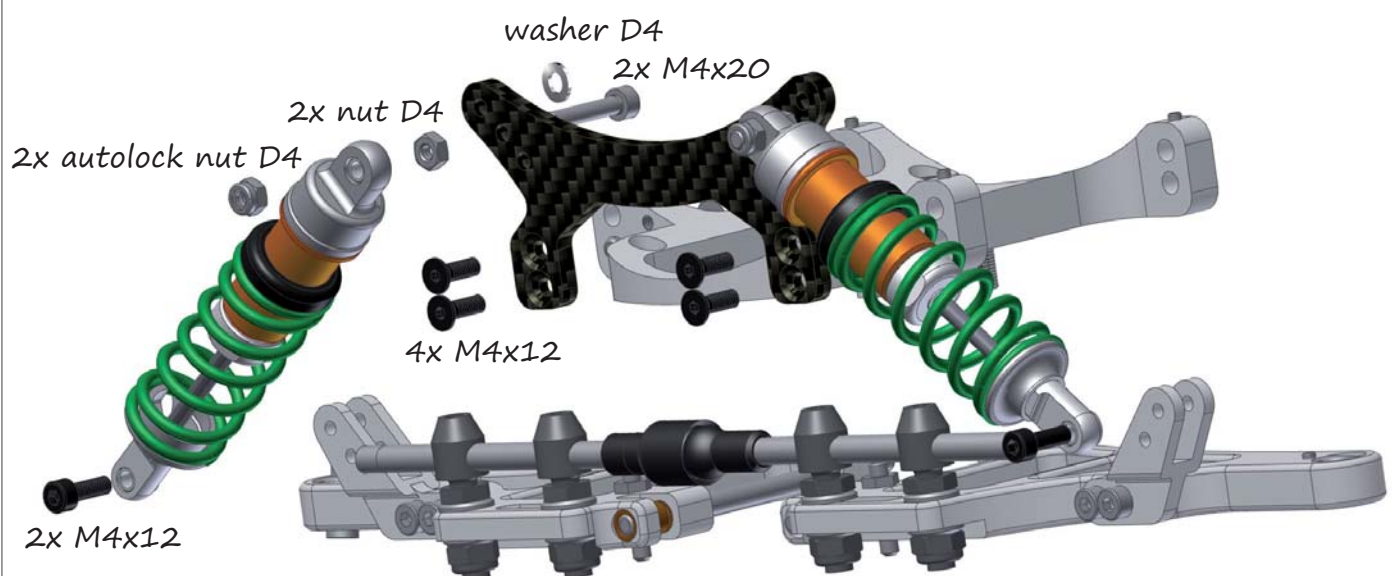

STEP 7 - CHASSIS

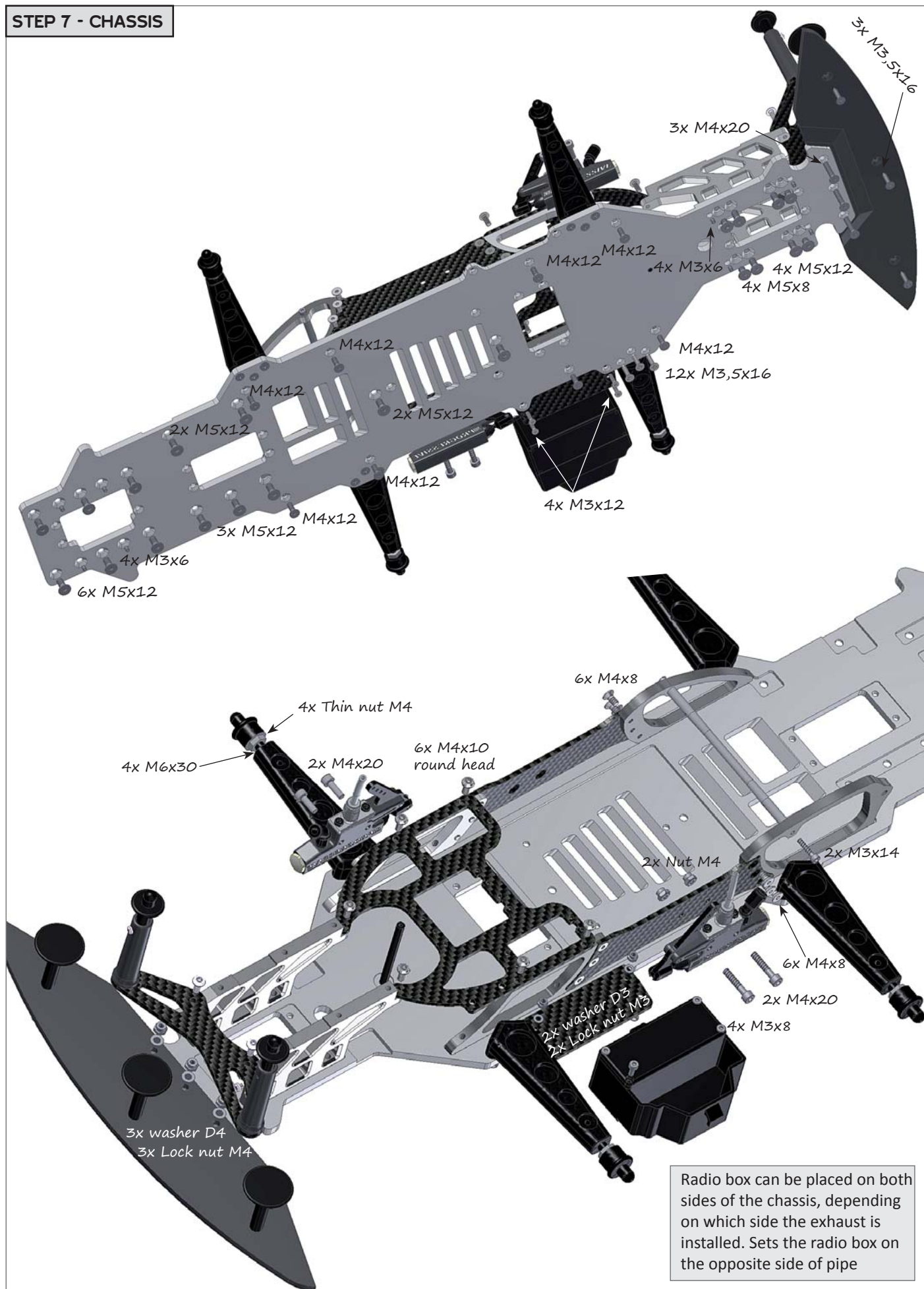

Radio box can be placed on both sides of the chassis, depending on which side the exhaust is installed. Sets the radio box on the opposite side of pipe

Remember apply liquid screwlocker with soft hardness in all the threads of screws or nuts. Special critic points that need higher hardnes of screwlocker will be detailed in the draws

STEP 8 - REAR DIFFERENTIAL HYBRID SELFLOCKING

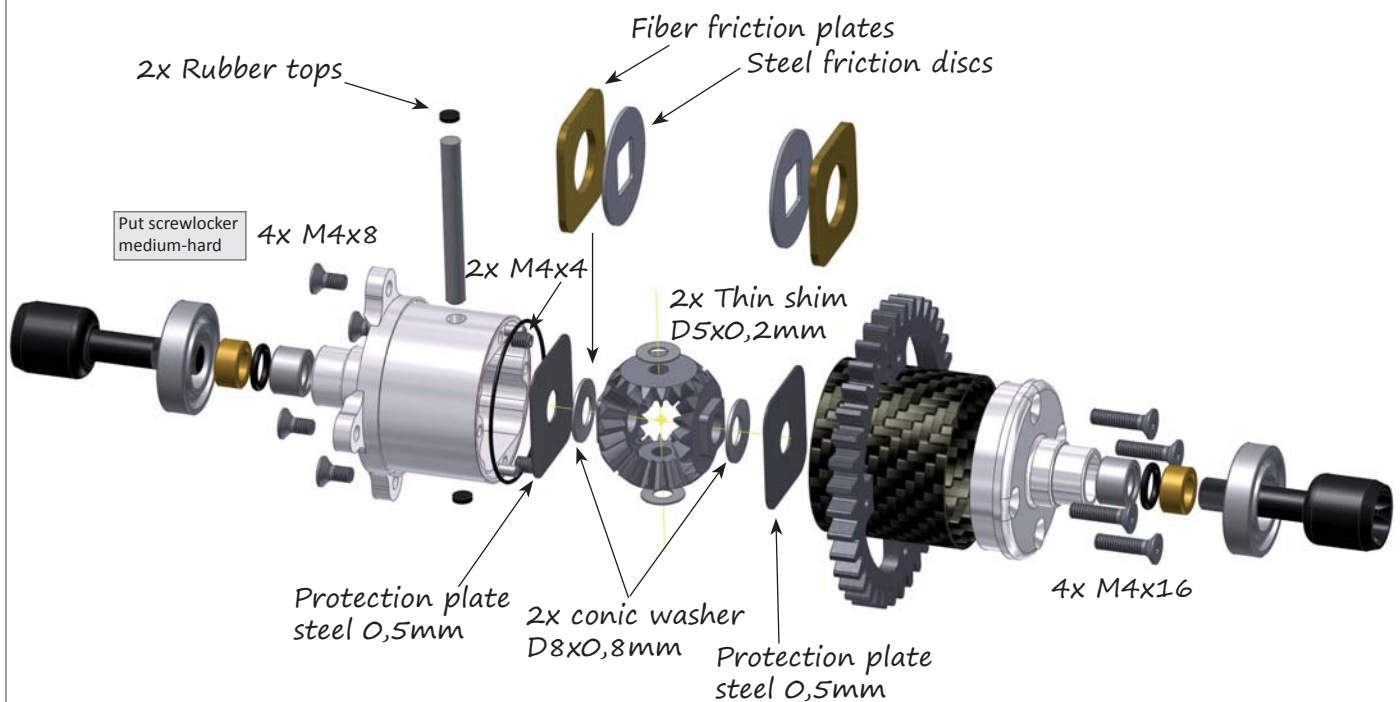

MECHANIC LOCK EFFECT.- Use different conic washers available to change the quantity of mechanic friction when throttle. Available wahsers are with thicker 0,4mm; 0,5mm; 0,6mm; 0,7mm; 0,8mm (in the kit) and 0,9mm. Thinner washers gives more friction and high lock effect. Thicker washers gives less friction and lowee lock effect. Using 0,9mm the effect is almost zero for rain conditions

VISCO LOCK EFFECT.- Use three different greases/oil included in the kit to get different general hardess of diff. Oil is best choice for low grip track and wet conditions in combination with thicker conic washers as 0,8mm or 0,9mm. Soft grease is good for medium grip condition, is the best choice as start point unsing washers 0,6mm o 0,7mm. White hard grease is only to use in tracks with good grip to get the maximum traction power in combination with thin conic washers as 0,4mm or 0,5mm.

STEP 9 - REAR UPRIGHT



The right and left rear uprights are identical and interchangeable.
The upper arms also are identical and interchangeable.

Remember apply liquid screwlocker with soft hardness in all the threads of screws or nuts.
Special critic points that need higher hardnes of screwlocker will be detailed in the draws

STEP 10 - REAR LOWER WISHBONE

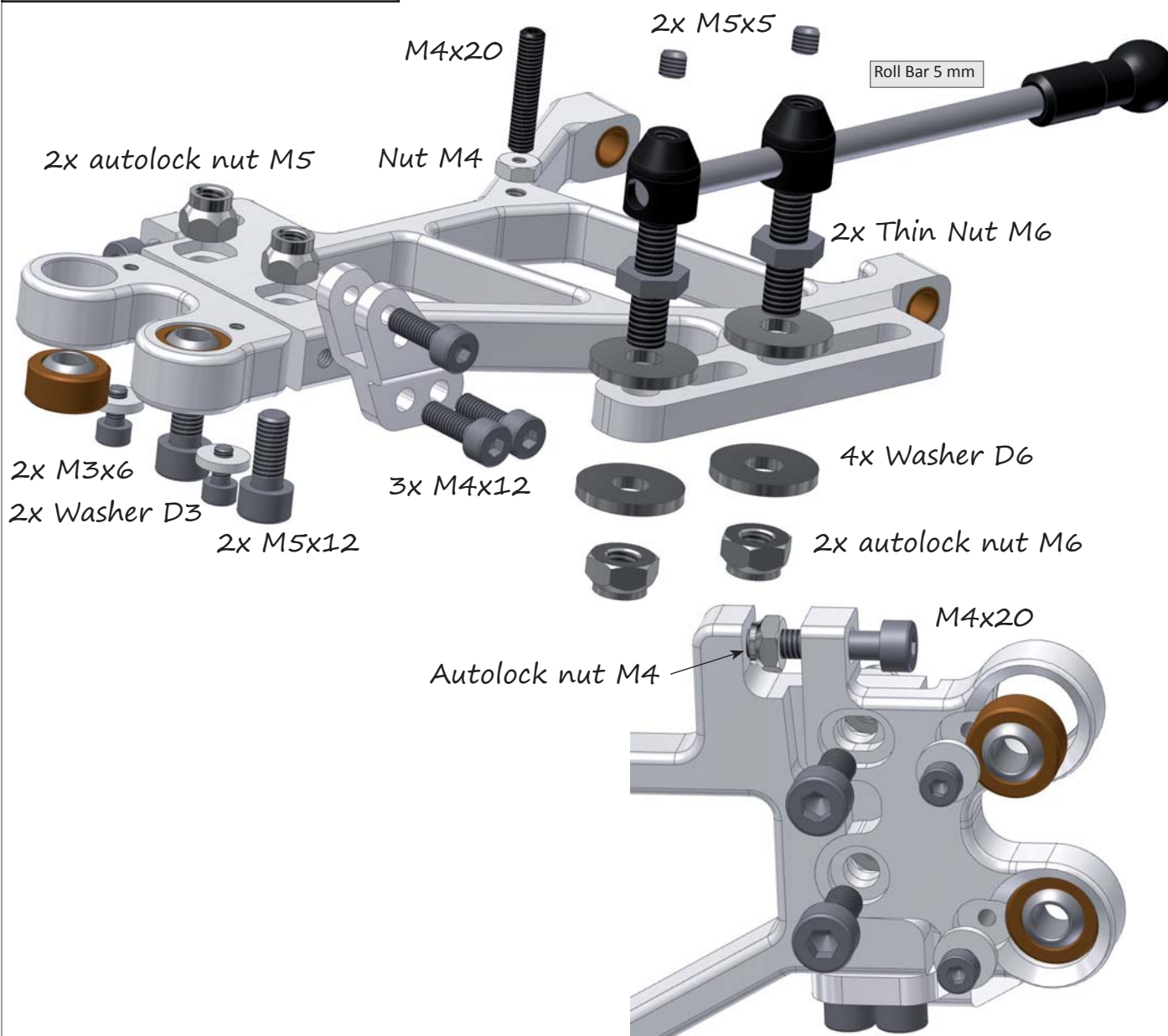

STEP 11 - REAR BODY SUPPORT

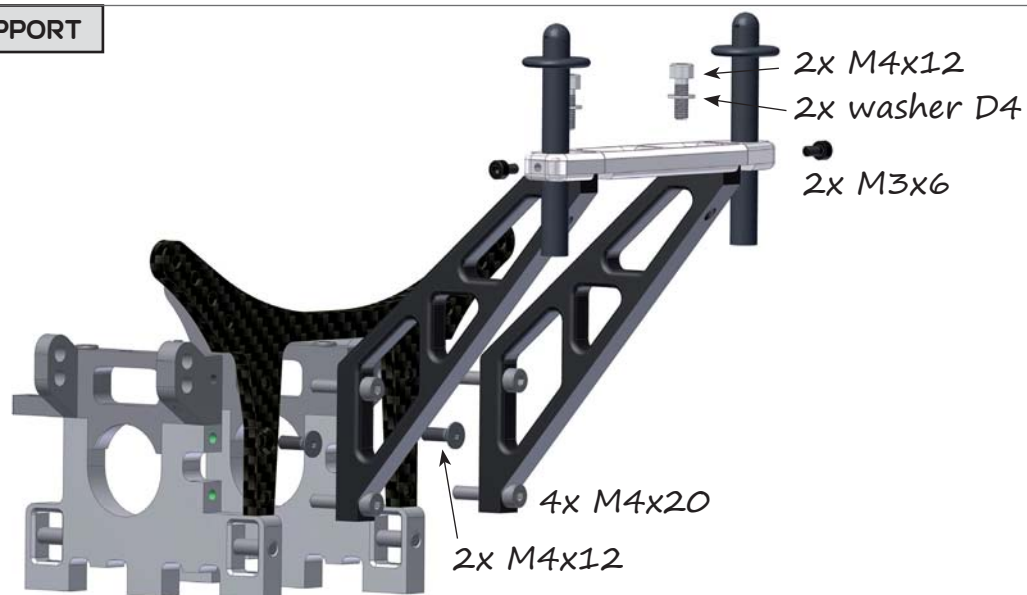

Remember apply liquid screwlocker with soft hardness in all the threads of screws or nuts. Special critic points that need higher hardnes of screwlocker will be detailed in the draws

STEP 12 - REAR AXLE

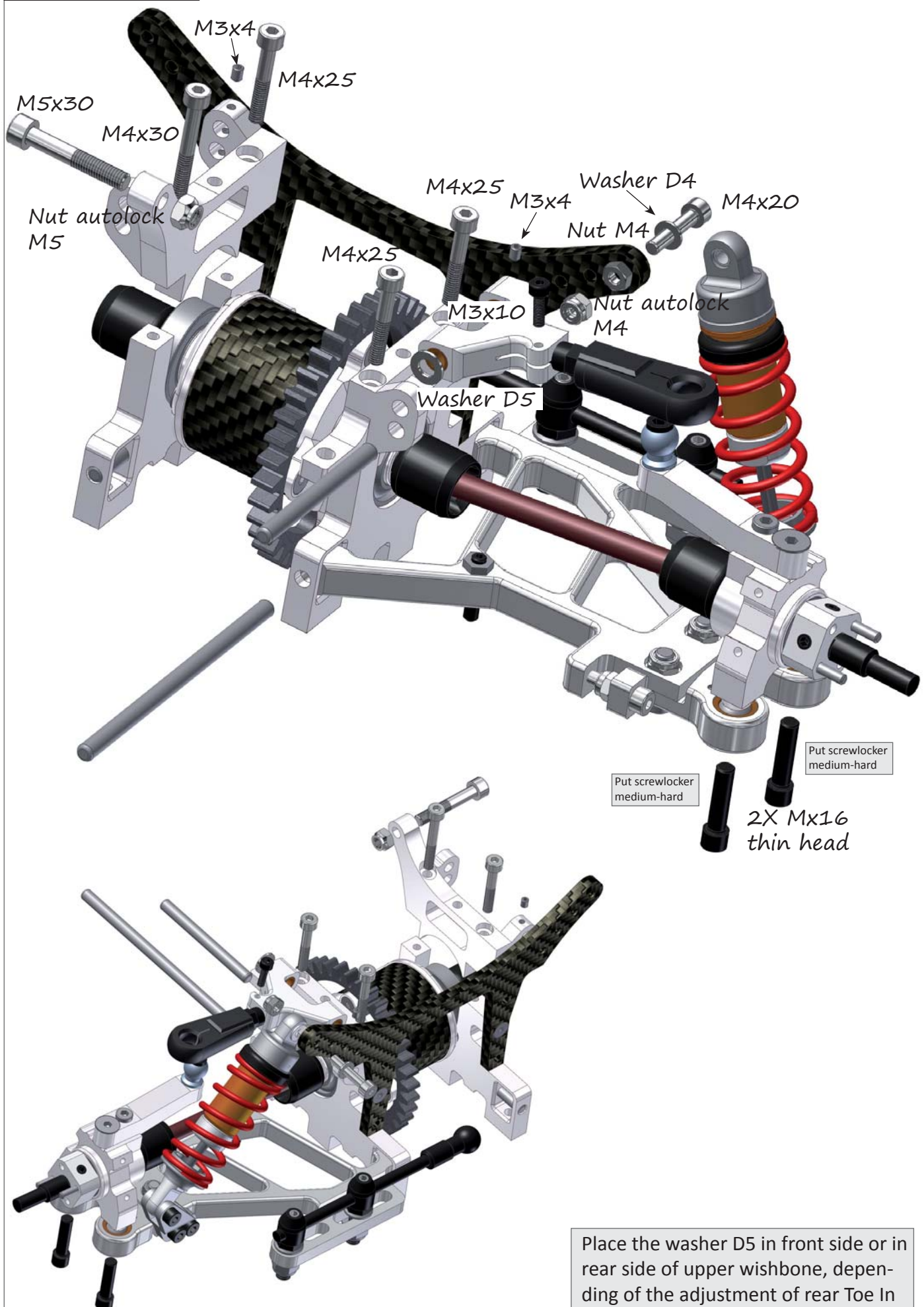

Place the washer D5 in front side or in rear side of upper wishbone, depending of the adjustment of rear Toe In

STEP 13 - TRANSMISION

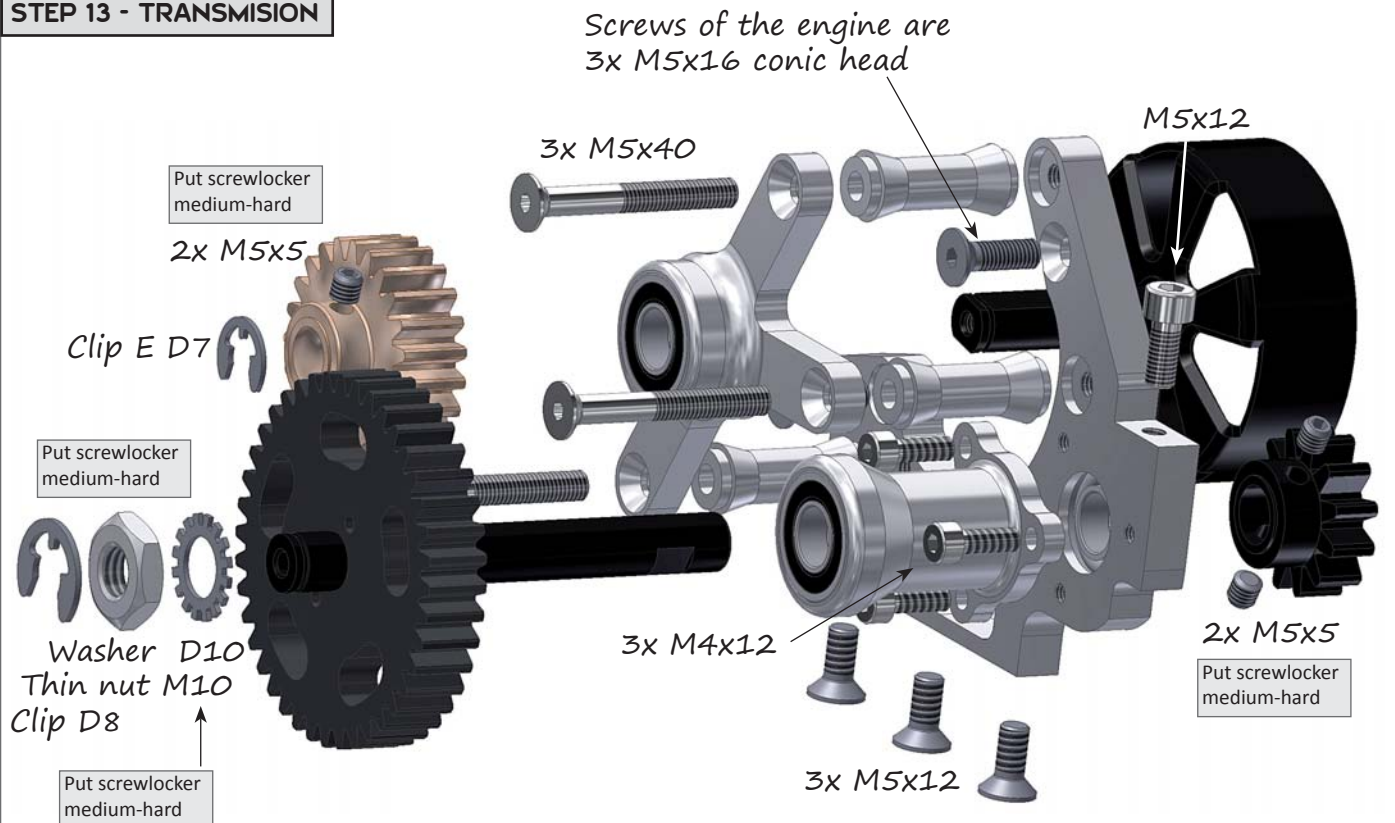

STEP 14 - ADJUSTABLE CLUTCH

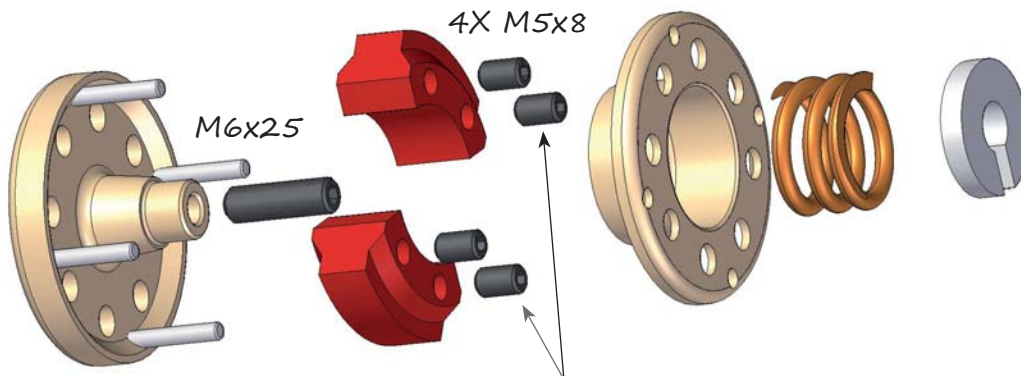

Use 4 x screws M5x8 inside the shoes and/or 4 shoes only if you want a soft performance as in rainy conditions or off road use. If you want a hard and fast racing acceleration use only two red shoes with 3.0 spring and no screws inside.

SPRING LEVELS

150202/55 Very soft spring 2,8 mm (optional)
 150202/6 Medium spring 2.9 mm (optional)
 150202/66 Hard spring 3.0 mm (Include in the kit)

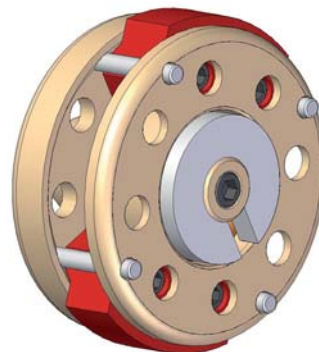

Adjust tension of spring by this special nut using a screwdriver through the clutch bell inside this cut. The correct adjust for on road use is between 9000 rpm to 11.000 rpm

STEP 15 - BRAKE MASTER CYLINDER

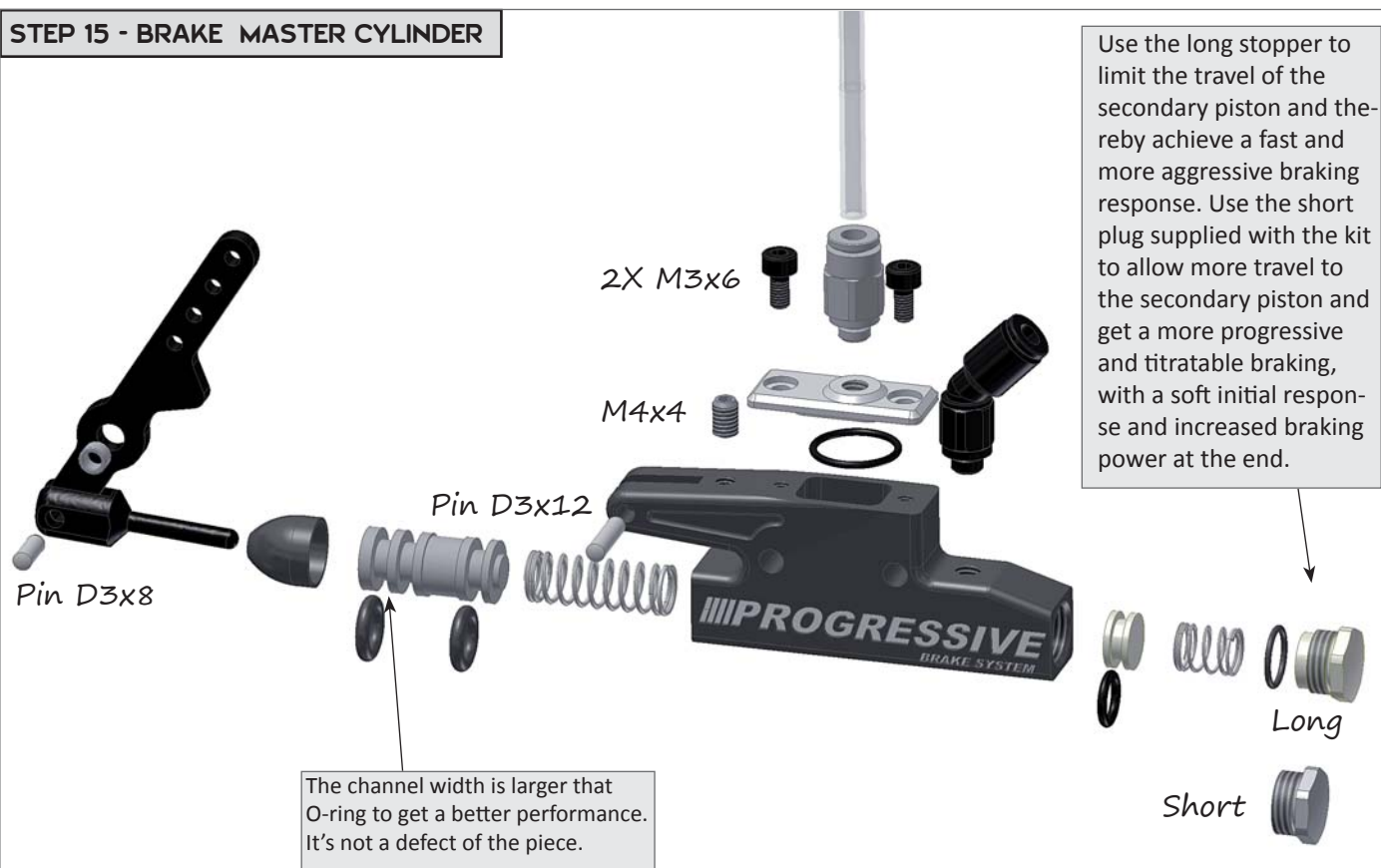

When assembling the O-rings in the piston and assembling the piston into cylinder, smear everything with soft grease; this will improve the bomb softness and will make the life of the joints longer.

STEP 16 - BRAKE CALLIPER



When assembling the O-rings in the pistons and assembling the pistons into calliper, smear everything with soft grease; this will improve the softness and will make the life of the joints longer.

STEP 17 - CALLIPERS AND DISCS

FRONT



REAR

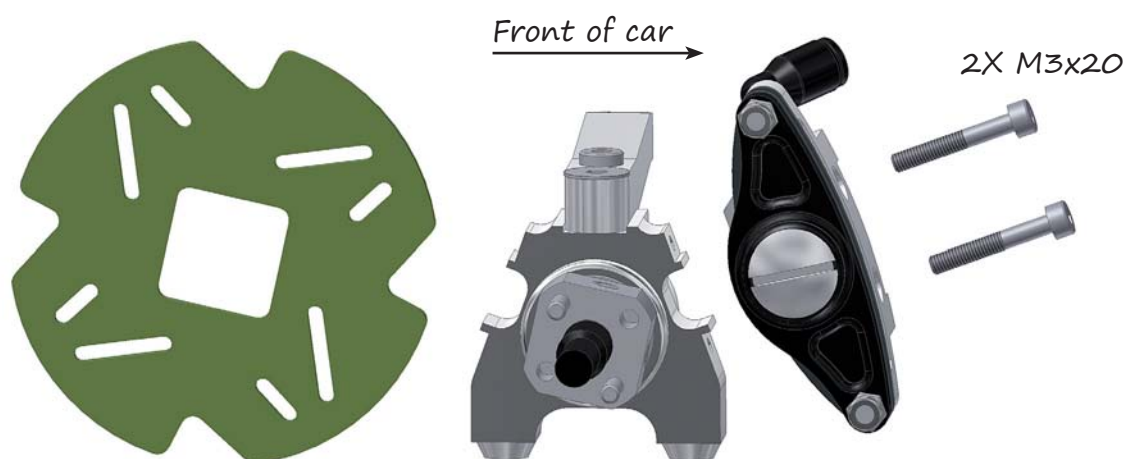

STEP 18 - SHOCK ABSORBERS

Optional associated parts:

150120/161 Closed piston shock, 2u.

150120/181 Piston shock set 2holesx1,6, 2u.

150110/x Spring sets

150111/xx Silicon oil

150097 Fast support shocks set 4u.

150101 Carbon front long damperplate

150103 Carbon rear damperplate

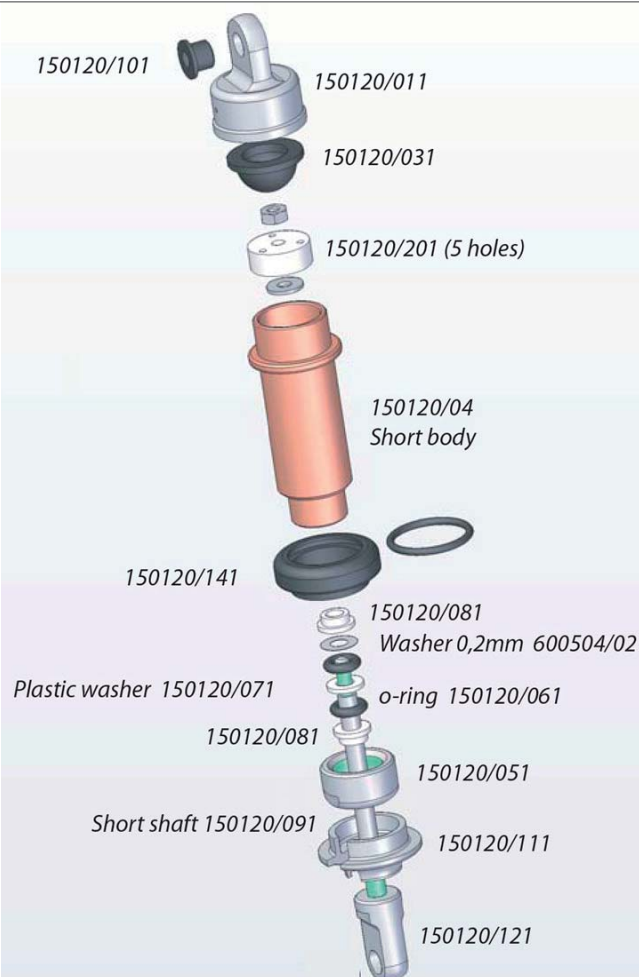

STEP 19 - INSTALLING THE ENGINE



Cut this part of the engine cover to allow the installation of the pipe "on the right side"

STEP 20 - TRANSMISION RATIOS

PRIMARY TRANSMISSION			SECONDARY TRANSMISSION				torque + + velocity
PINION	LAYSHAFT	RATIO 1	PINION	LAYSHAFT	RATIO 2	RATIO FINAL	
22	41	1,86-1	12	37	3,08-1	5,75-1	
22	40	1,82-1	12	37	3,08-1	5,61-1	
23	41	1,78-1	12	37	3,08-1	5,50-1	
22	39	1,77-1	12	37	3,08-1	5,47-1	
23	40	1,74-1	12	37	3,08-1	5,36-1	
24	41	1,71-1	12	37	3,08-1	5,27-1	
23	39	1,70-1	12	37	3,08-1	5,23-1	
24	40	1,67-1	12	37	3,08-1	5,14-1	
24	39	1,63-1	12	37	3,08-1	5,01-1	

STEP 21 - SCREW SET

Description	Quantity
Hexagonal screw 3 x 6	12
Hexagonal screw 3 x 8	4
Hexagonal screw 3 x 10	2
Hexagonal screw 3 x 14	2
Hexagonal screw 3 x 20	10
Hexagonal screw 4 x 10	2
Hexagonal screw 4 x 12	26
Hexagonal screw 4 x 14	2
Hexagonal screw 4 x 20	16
Hexagonal screw 4 x 25	5
Hexagonal screw 4 x 30	1
Hexagonal screw 5 x 12	5
Hexagonal screw 5 x 30	1
Special screw thin head 5 x 16	8
Special screw thin head 5 x 20	2
Hexagonal conic screw 3 x 12	4
Hexagonal conic screw 4 x 8	16
Hexagonal conic screw 4 x 12	14
Hexagonal conic screw 4 x 16	4
Hexagonal conic screw 4 x 20	3
Hexagonal conic screw 5 x 8	4
Hexagonal conic screw 5 x 12	17
Hexagonal conic screw 5 x 16	5
Hexagonal conic screw 5 x 40	3
Hexagonal screw round head 4 x 10	8
Sheet metal screw round head 3 x 10	2
Sheet metal screw 3,5 x 16	15

Description	Quantity
Hexagon set screw 3 x 4	6
Hexagon set screw 3 x 6	8
Hexagon set screw 4 x 4	10
Hexagon set screw 4 x 20	6
Hexagon set screw 5 x 5	20
Hexagon set screw 5 x 8	4
Hexagon set screw 6 x 25	1
Hexagon set screw 6 x 30	4
Standar nut M3	4
Standar nut M4	8
Autolock nut M3	10
Autolock nut M4	11
Autolock nut M5	5
Autolock nut M6	8
Autolock nut M8	1
Wheel nuts M6	4
Thin nut M6	12
Thin nut M10	1
washer D3	12
washer D4	11
washer D5	2
washer D6	16
Thrust washer D10	1
External circlip 8mm	1
External circlip 7mm	1
Calibrated shim 4 x 0,2mm	4
Calibrated shim 5 x 0,2mm	2
Spring conic washer D8 x 0,8mm	10

PART NUMBERS

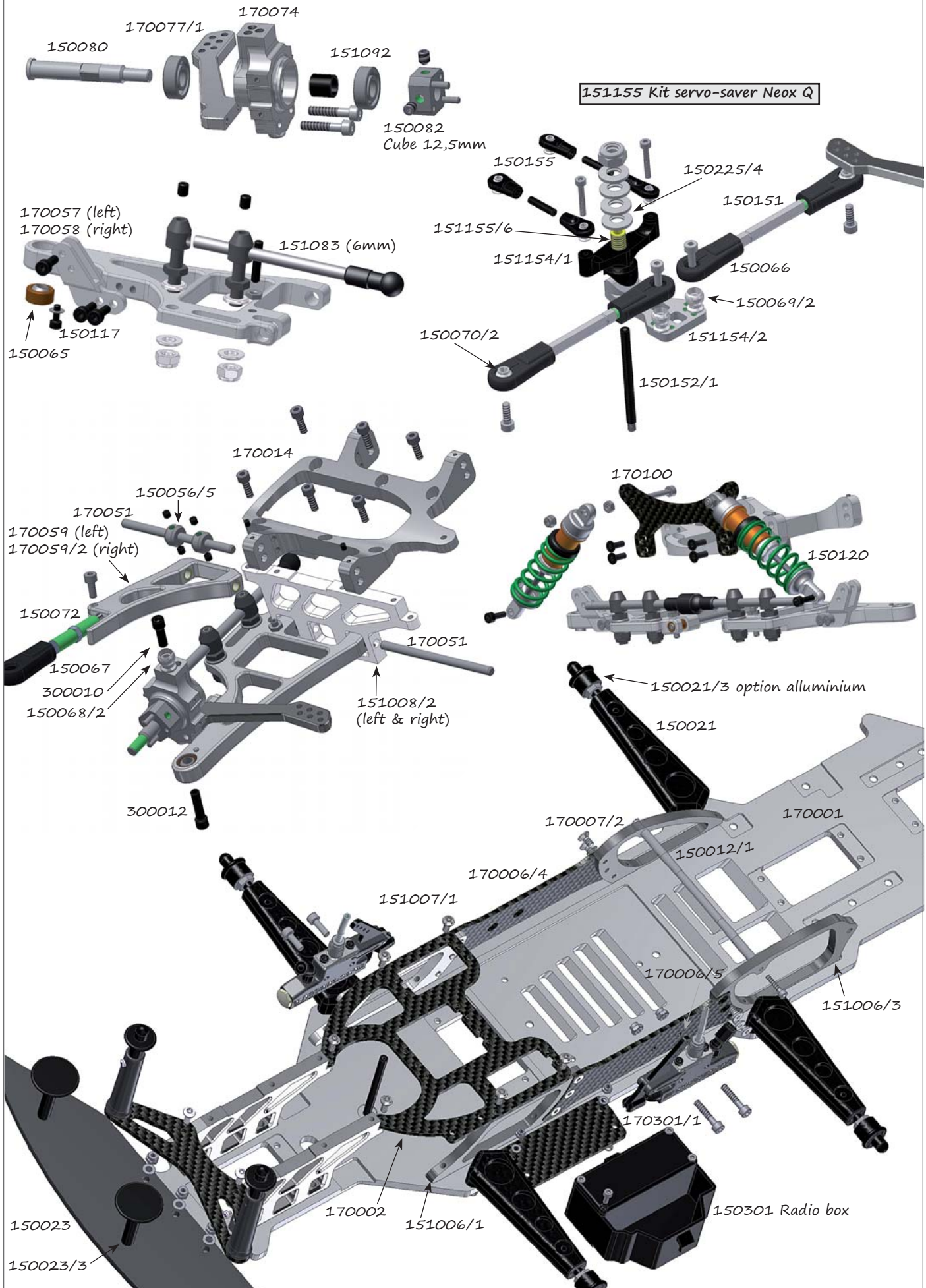

151020 Kit front body support

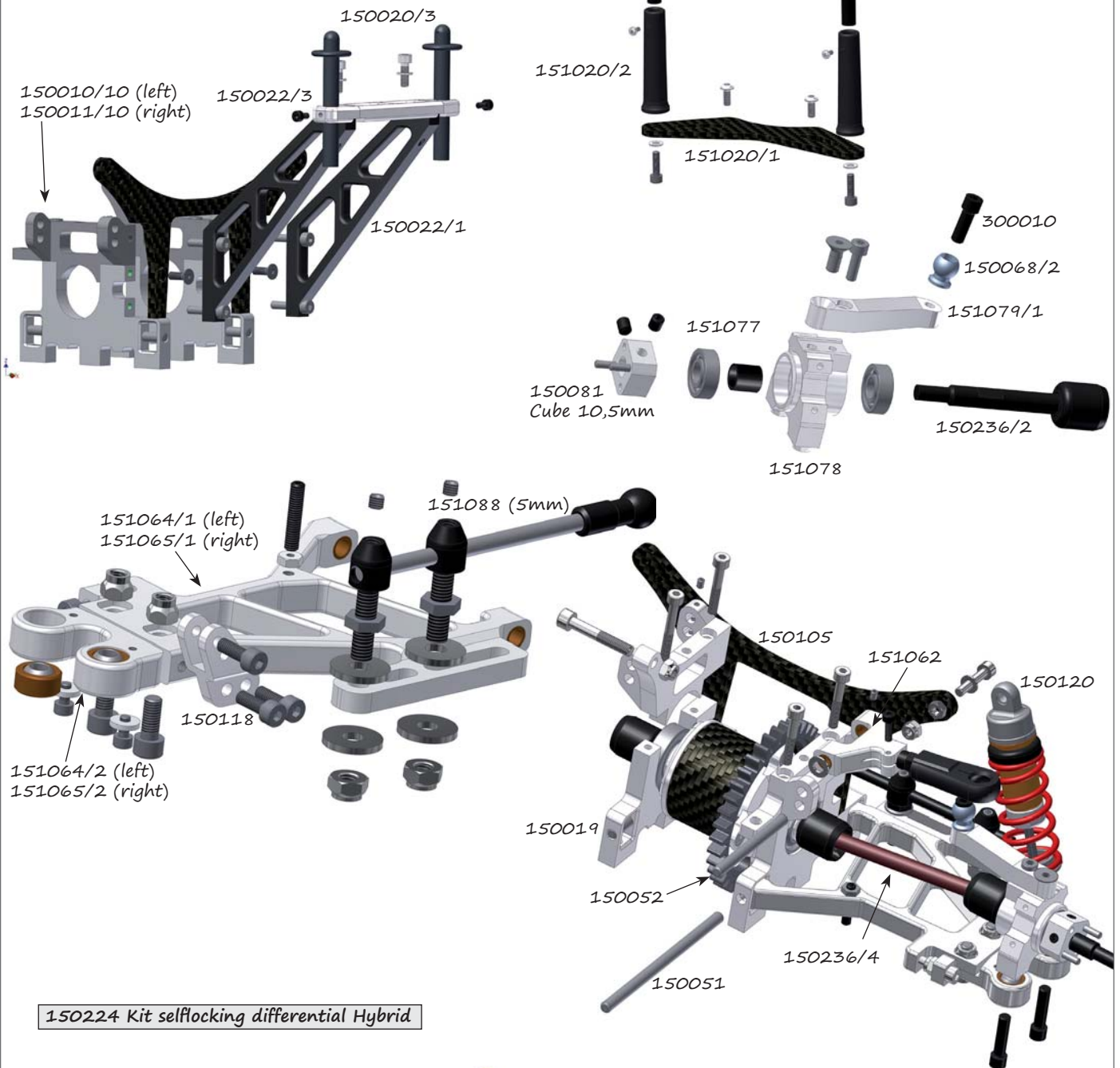

150224 Kit selflocking differential Hybrid

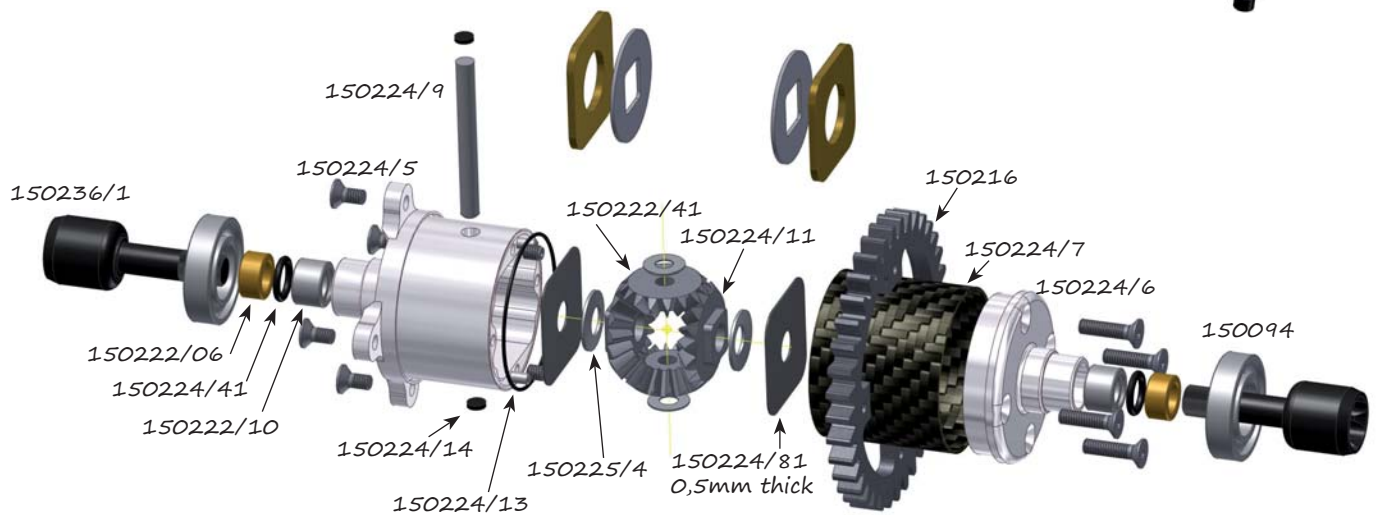

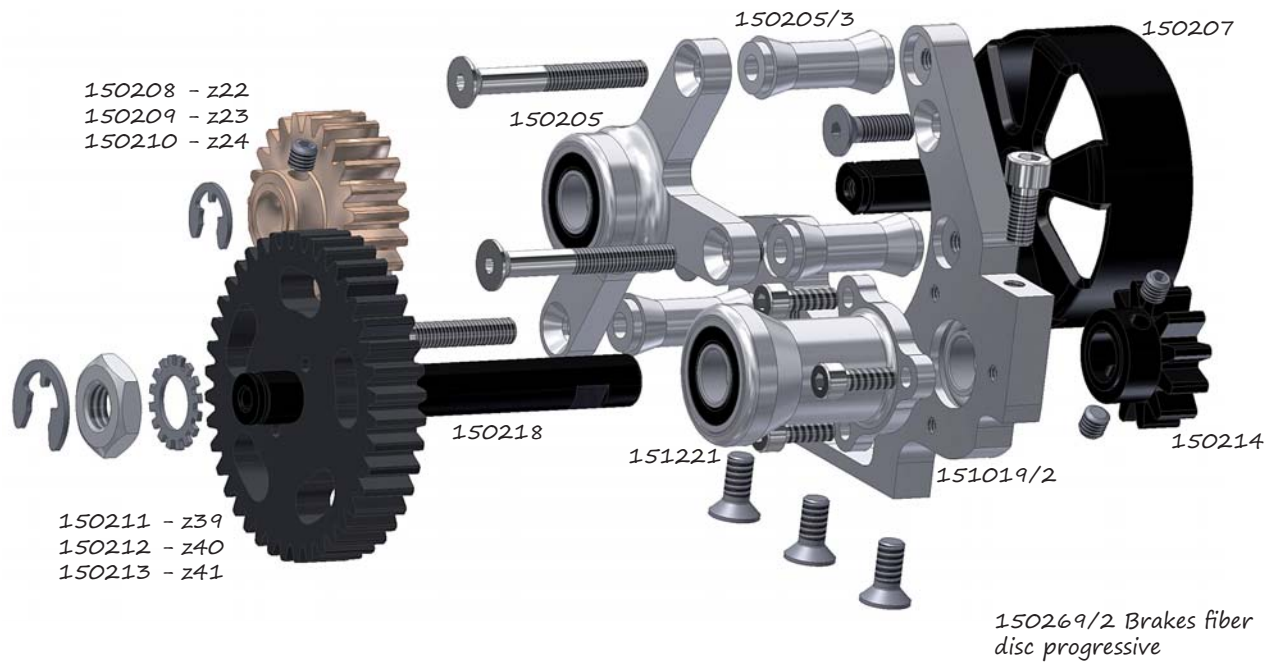

150201 Kit adjustable clutch

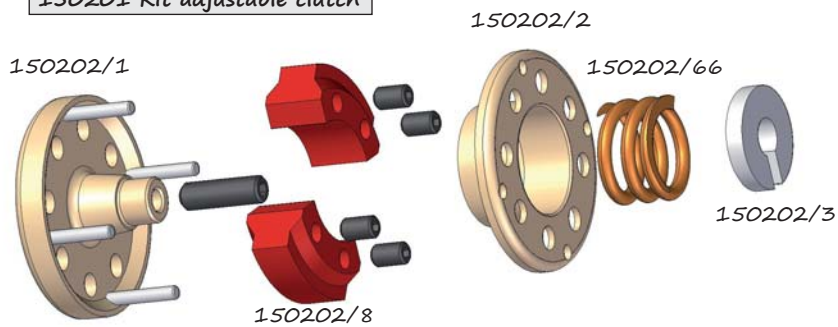

150278 Kit Progressive master cylinder



150280 Kit brakes calliper BIG MAC

